



- Printing speed :
  - 100mm/Hour

- Paper supply method :
  - Clamshell Type

### OPTIONS

- Alarm(AL1,AL2)

### DIMENSIONS AND PANEL CUTOUT

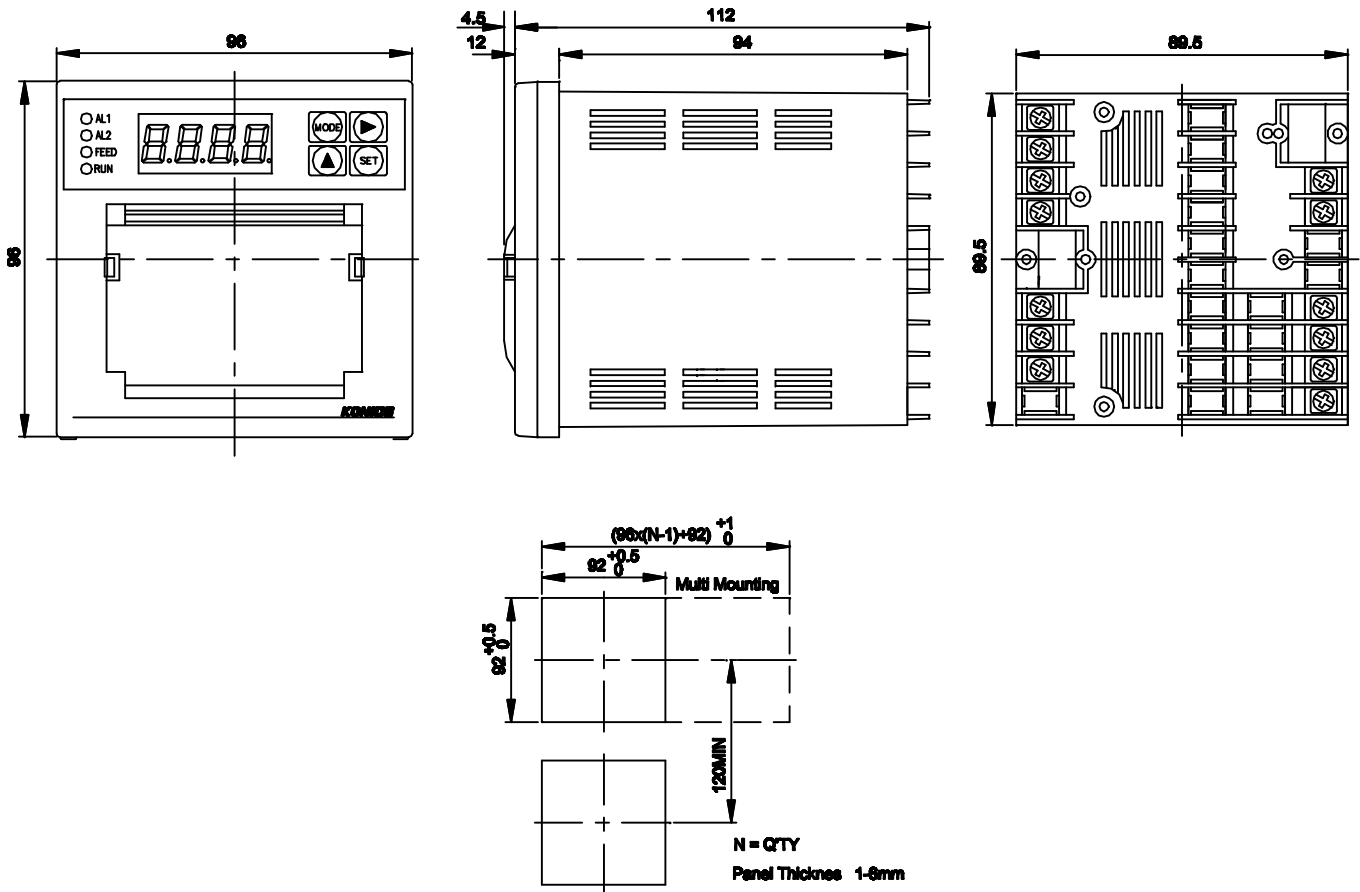

### CONNECTIONS

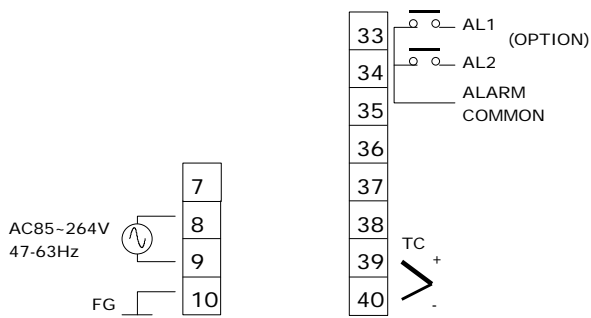

### ORDERING CODE

MODEL	INPUT	OPTION	CONTENT
BR-4000	K	-	TC-K (0°C -1300°C)
	R	-	TC-R (0°C -1750°C)
		N	NONE ALARM
		A	ALARM